



## **Description: Server room up to 20qm (200sqft) and backup room with up to 20qm**

*Monitoring in accordance with IT compliance of a standard server room with multiple IT cabinets, USV and climate system.*

*Additionally, there is another room with back-up systems, USV systems or other remote technology.*

*The rooms ought to be monitored for all major physical threats such as over temperature, high humidity and more. The monitoring system ought to be preferable simple, with manageable installing and investment efforts.*

In order to cover these requirements, you will need an AlarmManager-PRO and a MultiSensor-RF.

In the backup room a MultiSensor-LAN is used.

The MultiSensor-RF is connected to the AlarmManager with the included patch cable and is mounted on the server room ceiling using the included mounting bracket.

All measured values are transmitted to the AlarmManager via radio.

In the backup room the MultiSensor-LAN is also installed on the ceiling.

Here the connection is made over the network to a PoE-capable switch.

The AlarmManager takes over the complete monitoring and checks the predefined thresholds. If a threshold is exceeded, it sends an alarm to up to 1.000 users - via SMS, e-mail, SNMP and PUSH notification.

In order to monitor potential water ingress, a Kentix LeakageSensor-ROPE is installed which can be directly connected to the AlarmManager or the MultiSensor-LAN.

# System topology

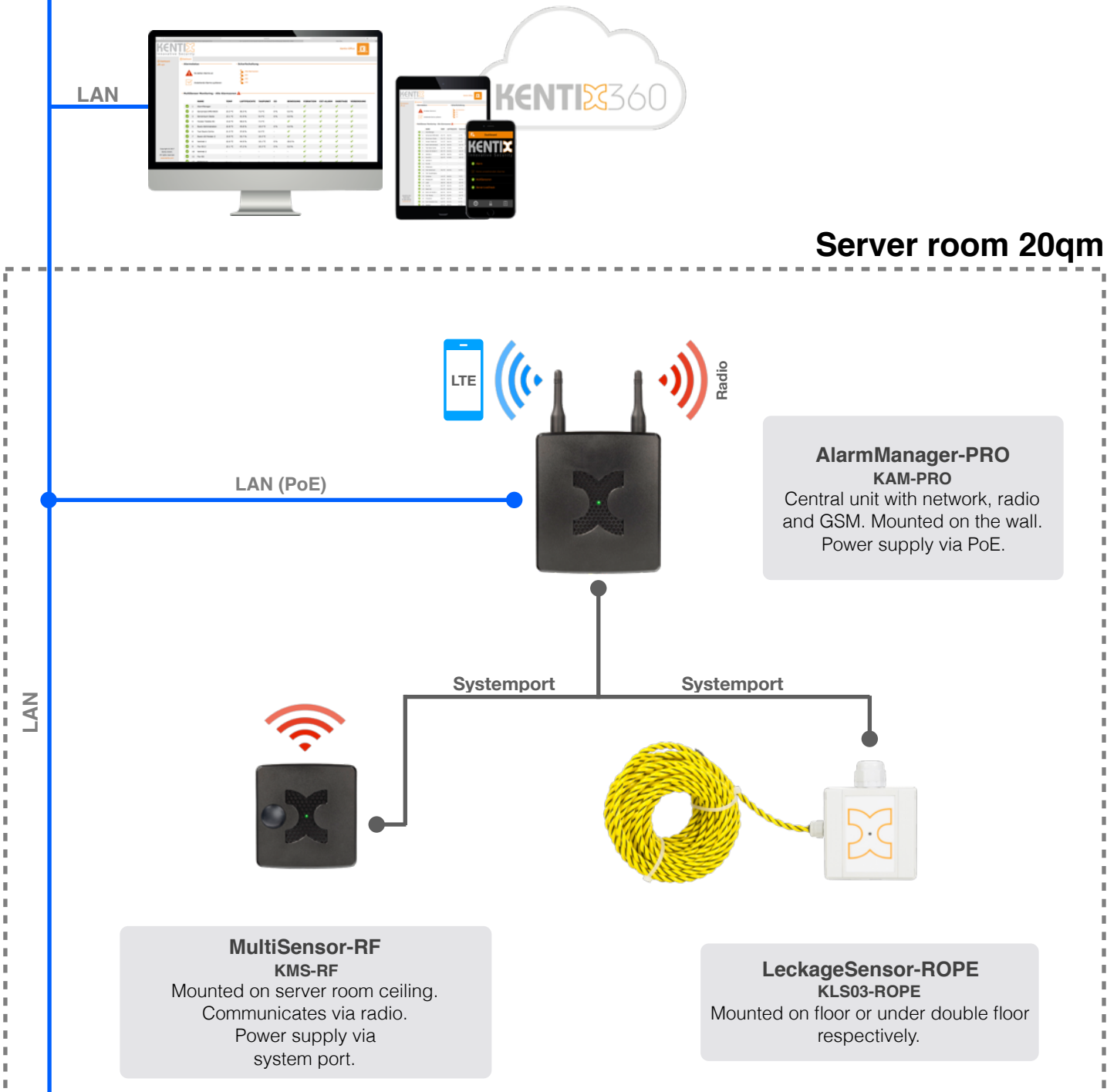

## Backup room 20qm

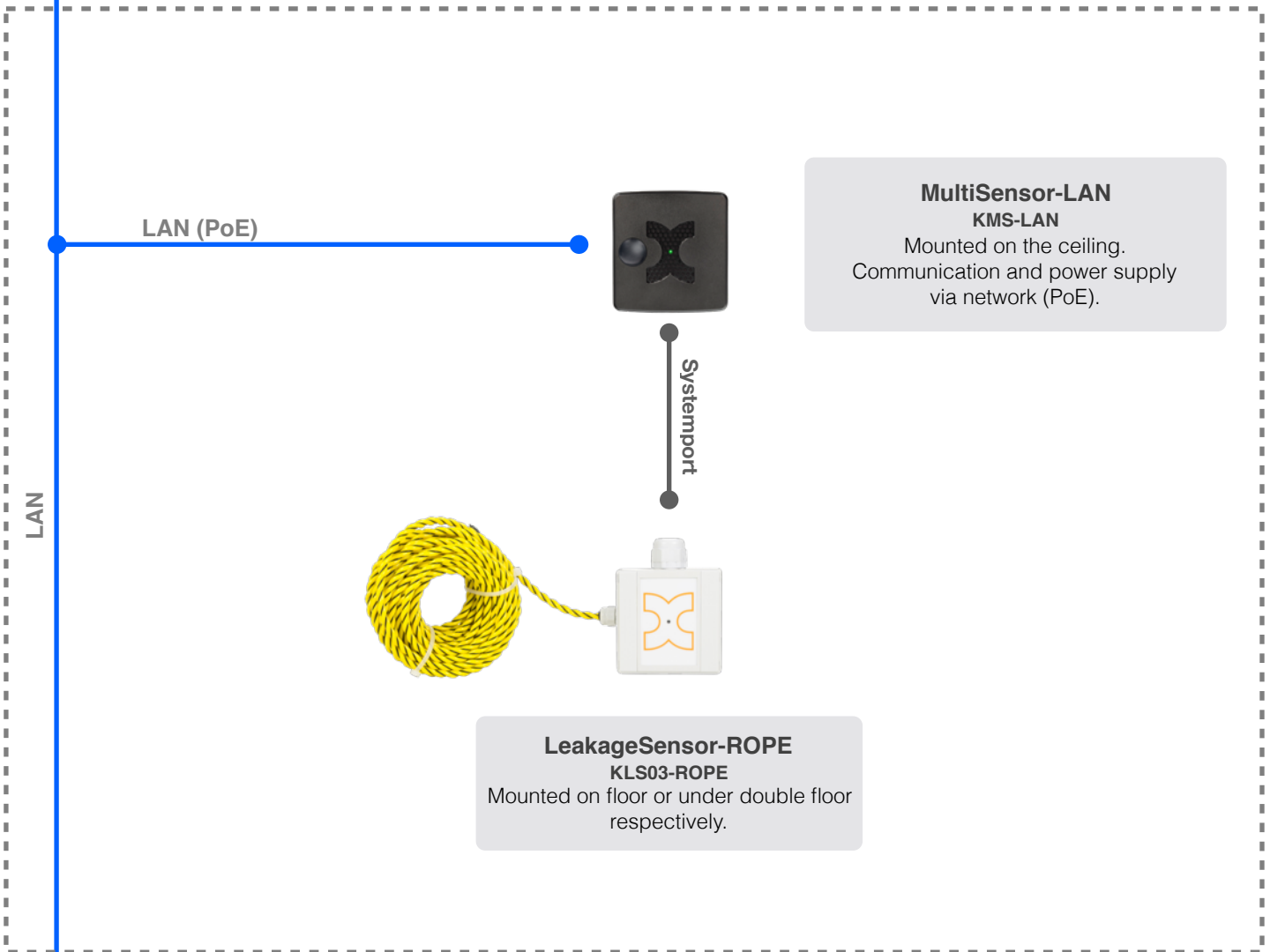

**Mounting and configuration in total: approx. 3-4 hours**

# System topology

## Extensions



### MultiSensor-DOOR KMS-DOOR

Battery powered MultiSensor for protection of windows and doors via a vibration sensor and magnetic contact.



### KeyPad-Touch KKPT

Battery powered operating panel for the regulation of motion detectors inside the MultiSensors or the burglar alarm function respectively.



### Camera (Indoor)

In case of an alarm, the AlarmManager can send an HTTP call to a network camera. The camera will begin recording or send pictures via e-mail.

LAN

LAN

## Parts list - Ordering assistance

Device name	ART-NR	Quantity	Price in EUR
AlarmManager-PRO	KSS-PRO-B	1	940,00 €
MultiSensor-RF	KMS-RF	1	395,00 €
MultiSensor-LAN	KMS-LAN-B	1	475,00 €
LeckageSensor-ROPE	KLS03-ROPE	2	from 370,00 €

## Extensions

Device name	ART-NR	Quantity	Price in EUR
MultiSensor-DOOR	KMS-DOOR	1	155,00 €
KeyPad-Touch	KKPT	1	490,00 €
Camera	M3105-LVE	1	369,00 €

All prices are list prices plus VAT.  
Our offer is only addressed to business customers.